

## INSTALLATION TIPS

### Concrete

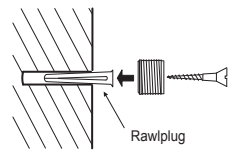

1

### Wood

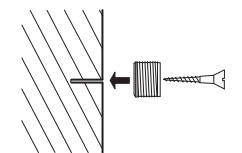

2

### Lathe & Plaster

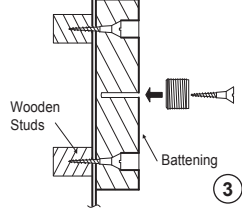

3

### Plasterboard

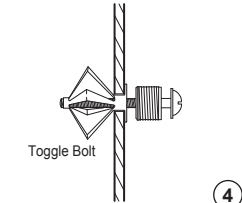

4

### Need a longer support?

Join two supports together using PC31.

### Double Depth Panels...

Make a strong design statement by using one panel in front of another, thus creating a double depth sign. This look can be achieved by joining two supports with the PC31. These supports can accommodate up to 6mm thick.

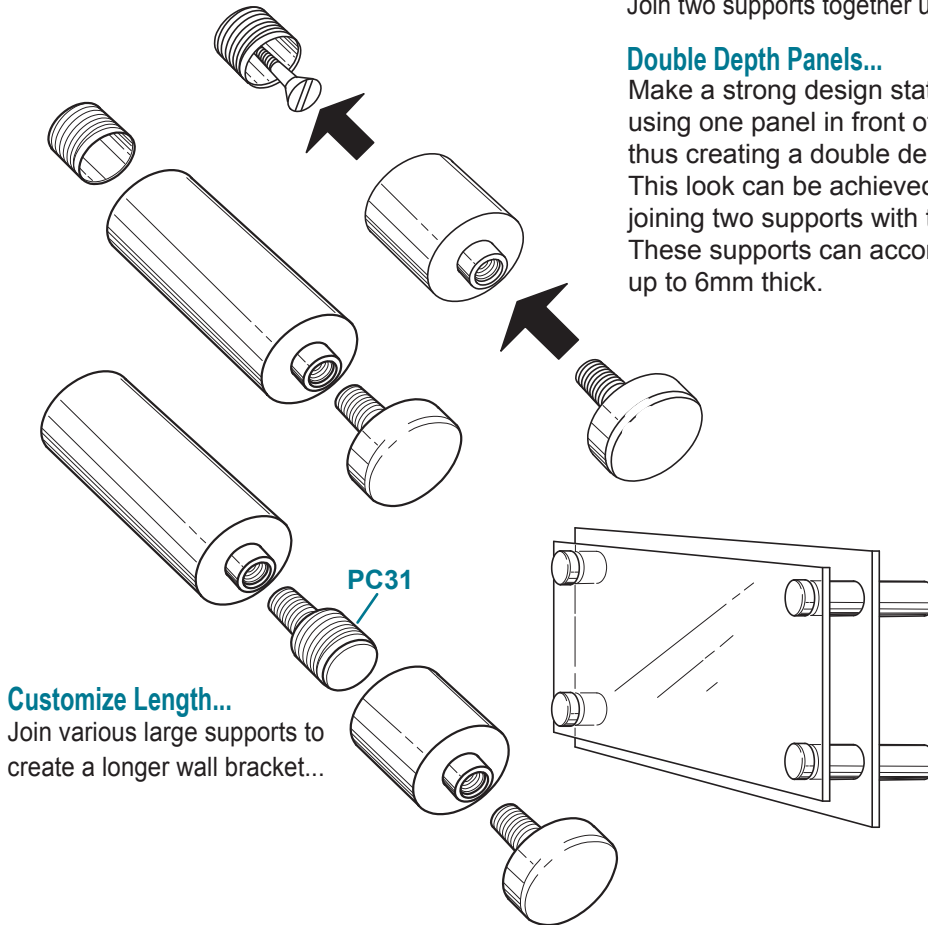

### Customize Length...

Join various large supports to create a longer wall bracket...

## Fixing Options

### Wall Mounting

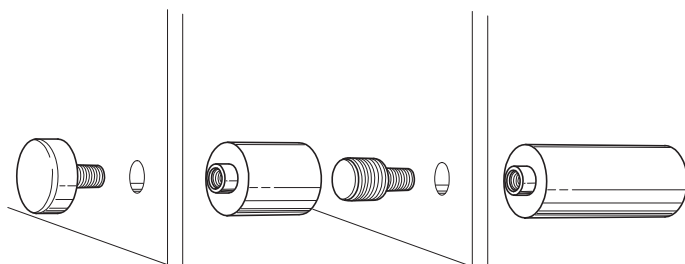
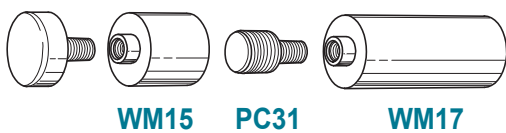

### Countertop Mounting

