

1.5mm Cable Display Systems - INSTALLATION GUIDELINES

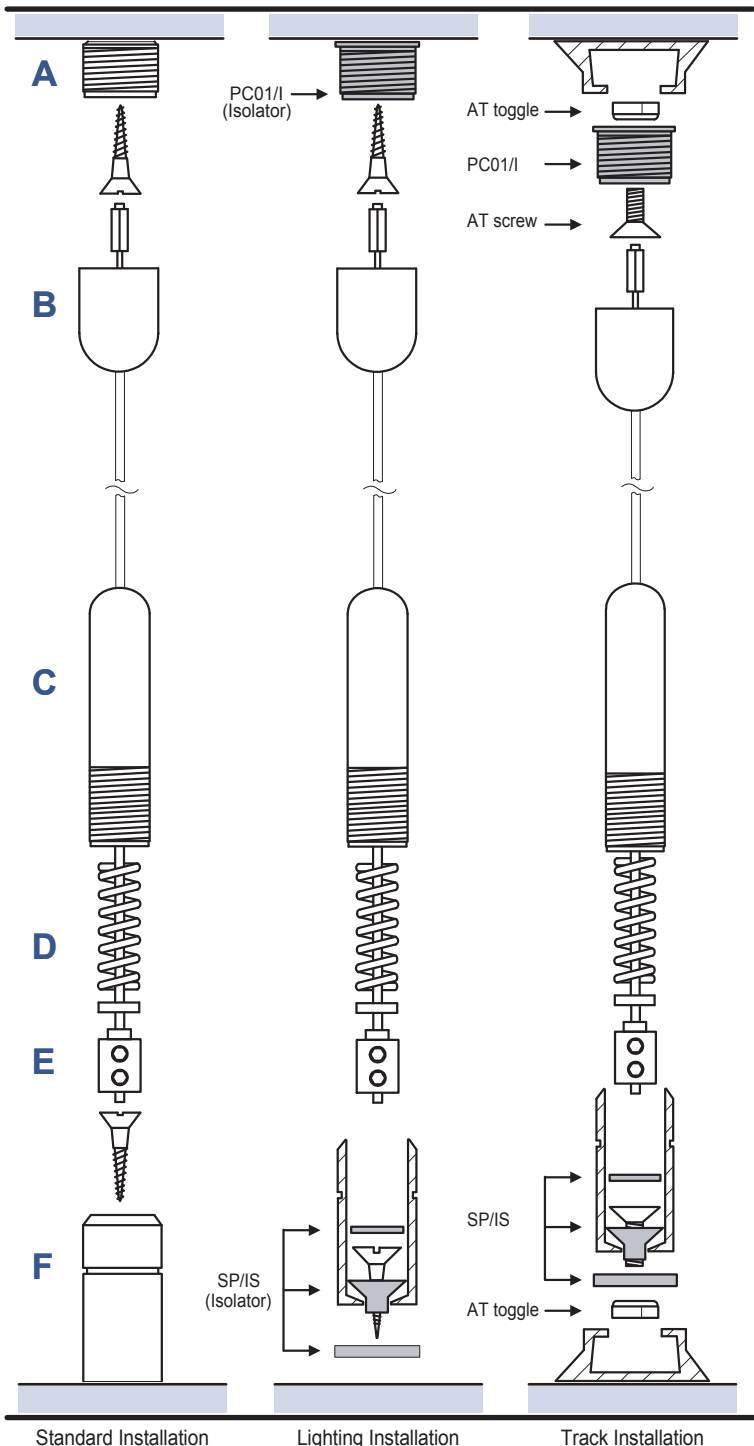
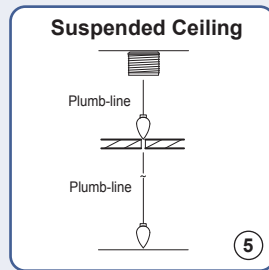
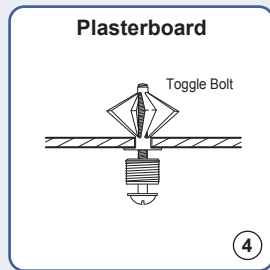
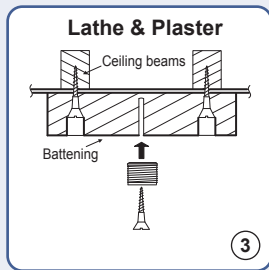
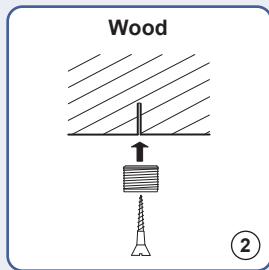
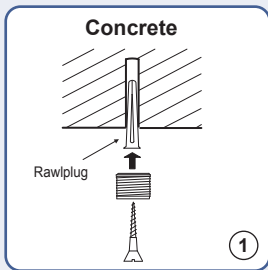

Top to Bottom (CA4) - Cable Installation

IMPORTANT: It is essential to check that the top ceiling fixings are strong enough to take the weight of the items being displayed, whilst allowing for the tension in the cables.

Isolators must be used where power is required through the cables (lighting etc) and fixings are into metal or conductive materials.

When fitting isolated cables remember to replace the top brass fitting with the plastic **PC01/I** isolator and add bottom isolator **SP/IS** to bottom fitting.

- 1) Fix fitting (A) to ceiling:
 - for wooden ceilings use a wood screw.
 - for cavity ceilings use a spring toggle bolt.
 - for solid ceilings use a rawlplug and screw.
- 2) Screw fitting (B) to fitting (A).
- 3) Using a plumb-line, plumb down from (A) and fix (F) to floor using appropriate type of fixing. For isolated cable remember to include the **SP/IS**.
- 4) Loosen the grub screws in fitting (E), using the allen key provided and slide fittings (C), (D) and (E) up the cable.
- 5) Pull down the cable and cut off in line with the decorative line around fitting (F) (see below).
- 6) Re-tighten (E) on the end of the cable.
- 7) Adjust the tension of the cable by screwing (C) into (F).

N.B. It is important to check the strength of the top fixing. No responsibility will be taken for incorrect fixing. This responsibility rests with the installer.

Cables are not supplied with fixing screws.

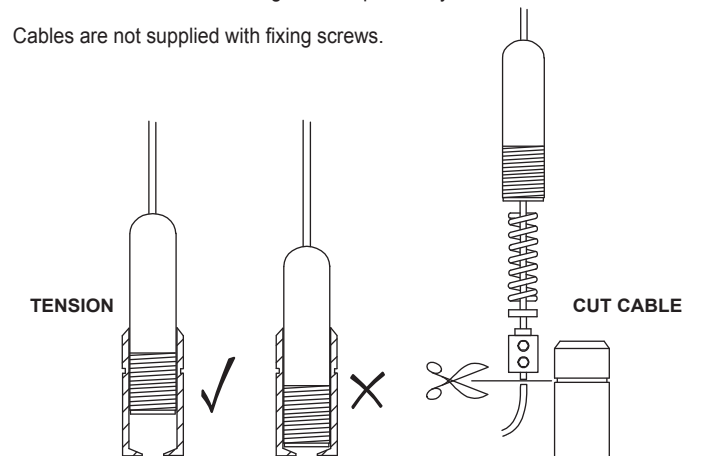

1.5mm Cable Display Systems - INSTALLATION GUIDELINES

Panel Fixing - CG01 & CG02 Support Installation

1) Attach a clamp support to each corner of vertical panel at min. 1" distance from edge (fig 1).

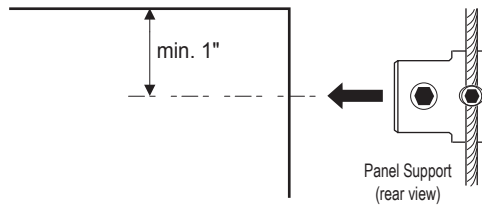

fig 1

2) Use additional clamp supports for panels taller than 60 inches to avoid bowing.

3) **Mark cable positions on floor area** - measure the distance between cable centers and mark cable positions on floor. With the use of a plumb line mark and fix cables to ceiling (ensuring that fixings are secure).

5) Install cables as per "Cable Fixing Instructions" for CA4 supplied.

6) Fix panels onto cables. Adjust panels vertically and horizontally, preferably with a spirit level. Repeat procedure for other panels.

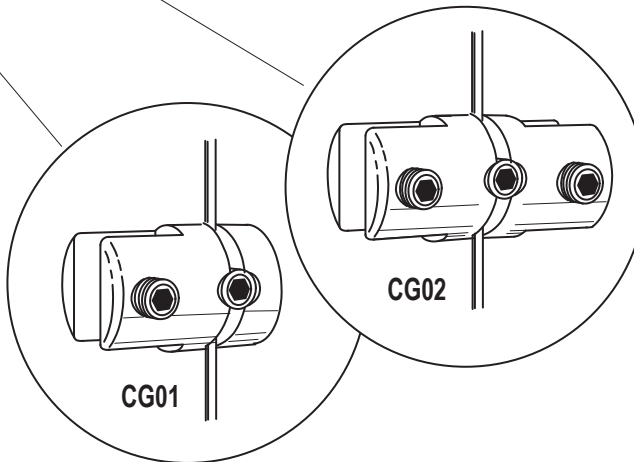
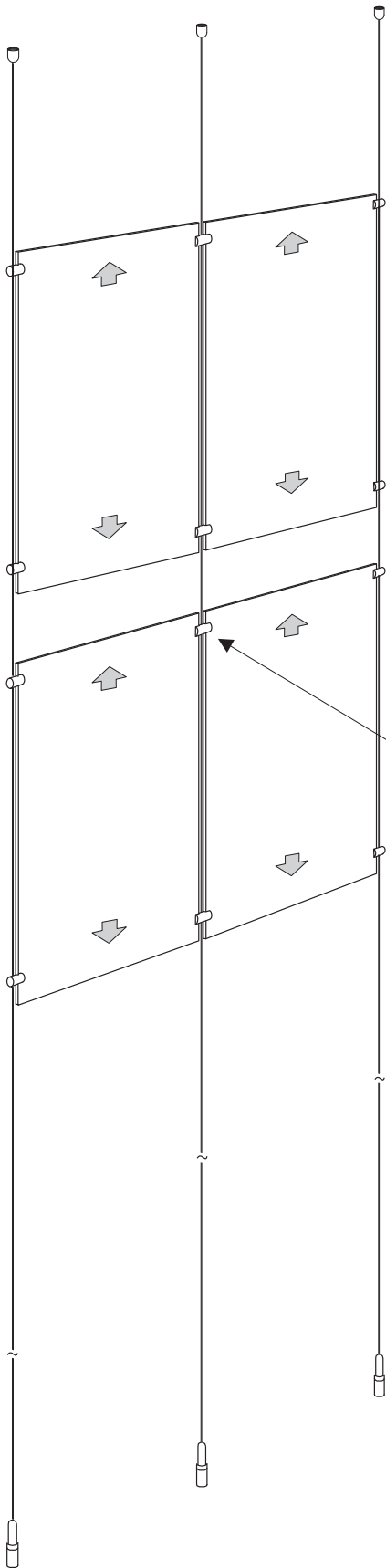

INSTALLATION TIPS

Concrete

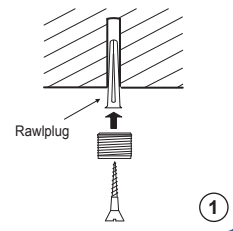

Wood

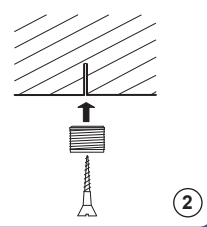

Lathe & Plaster

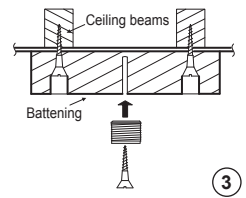

Plasterboard

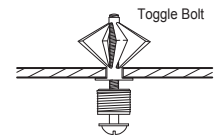

Suspended Ceiling

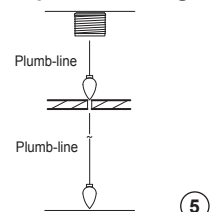

1.5mm Cable Display Systems - INSTALLATION GUIDELINES

Panel Fixing - CG14 & CG08 Support Installation

1) Attach a clamp support to each corner of vertical panel at min. 1" distance from edge (fig 1).

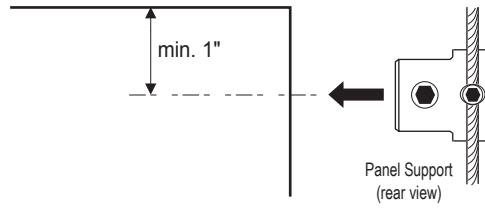

fig 1

2) Use additional clamp supports for panels taller than 60 inches to avoid bowing.

3) **Mark cable positions on floor area** - measure the distance between cable centers and mark cable positions on floor. With the use of a plumb line mark and fix cables to ceiling (ensuring that fixings are secure).

5) Install cables as per "Cable Fixing Instructions" for CA4 supplied.

6) Fix panels onto cables. Adjust panels vertically and horizontally, preferably with a spirit level. Repeat procedure for other panels.

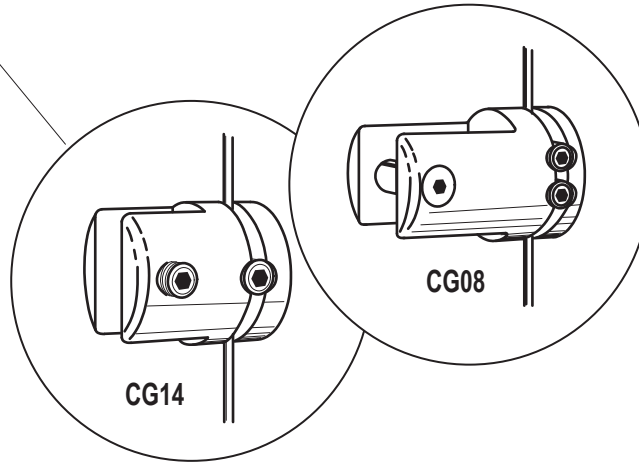

7) Using CG08 clamp support require drilling the panel (fig 2).

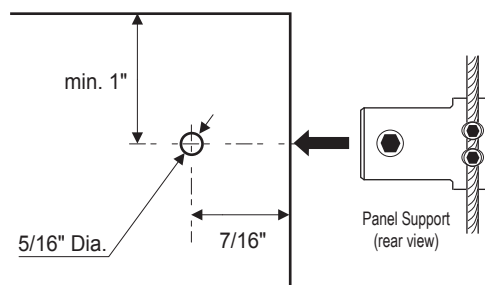
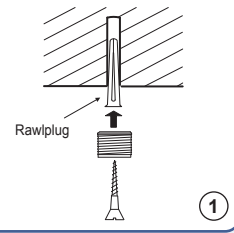

fig 2

INSTALLATION TIPS

Concrete



1

Wood

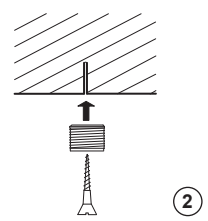

2

Lathe & Plaster

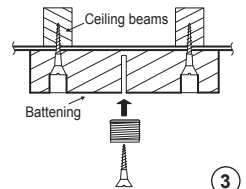

3

Plasterboard

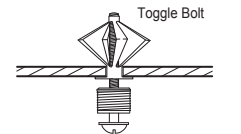

4

Suspended Ceiling

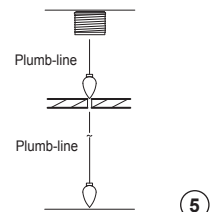

5

6mm Rod Display Systems - INSTALLATION GUIDELINES

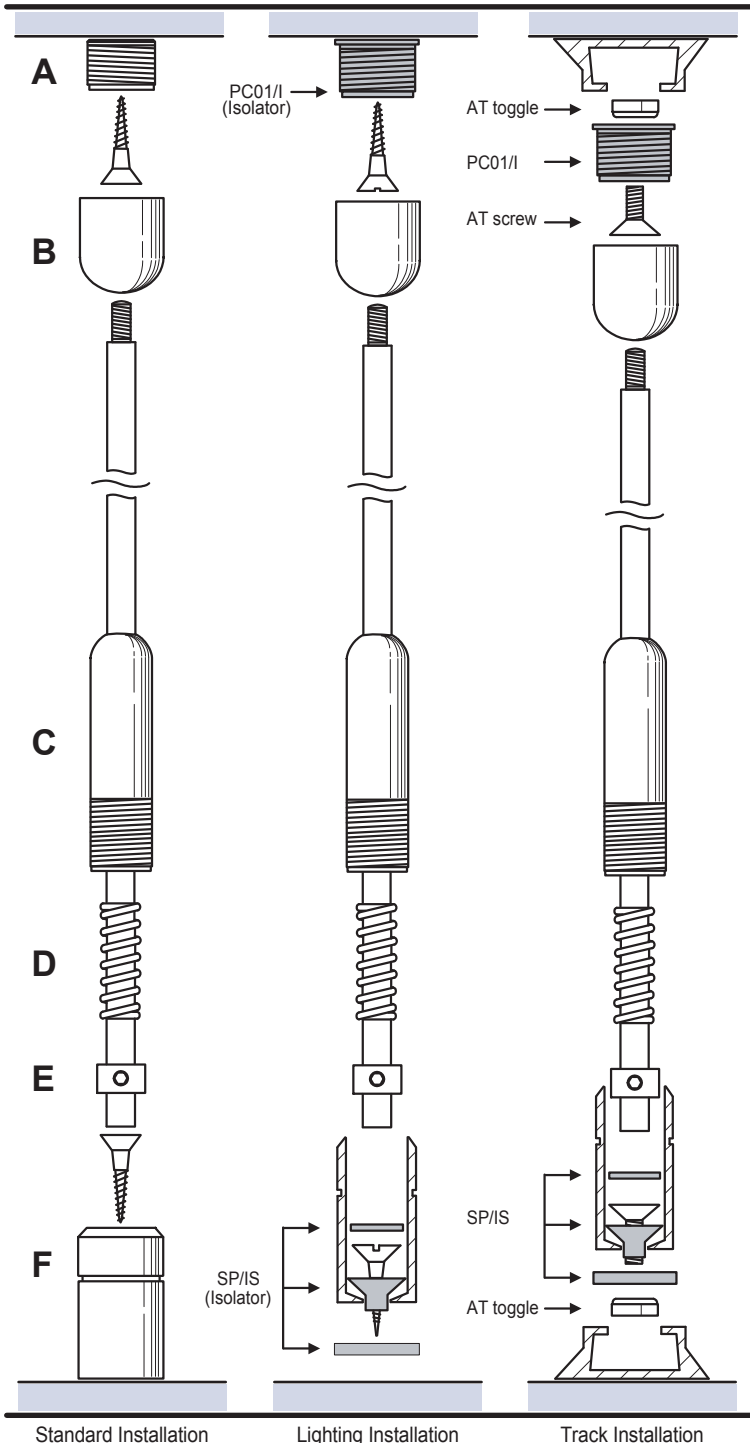
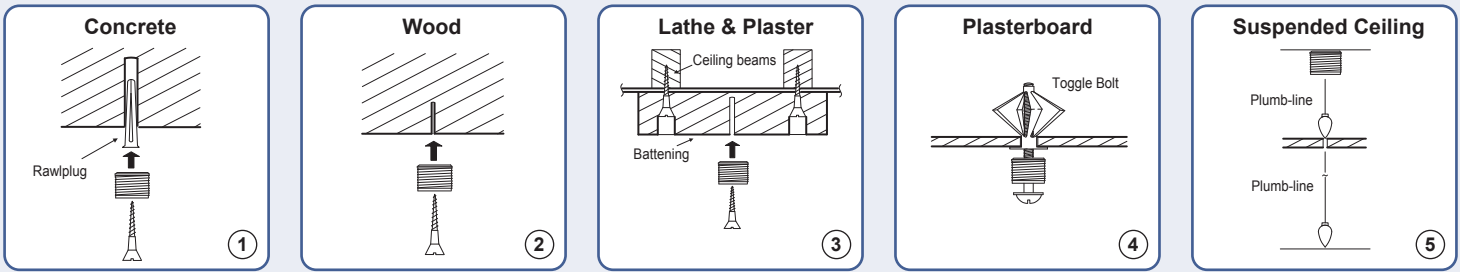

Top to Bottom (RAS) - Rod Installation

IMPORTANT: It is essential to check that the top ceiling fixings are strong enough to take the weight of the items being displayed, whilst allowing for the tension in the rods.

Isolators must be used where power is required through the rods (lighting etc.) and fixings are into metal or conductive materials. Remember to replace the top brass fitting with the plastic **PR01/I** isolator and add bottom isolator **SP/IS** to bottom fitting.

- 1) Fix fitting (A) to ceiling:
 - for wooden ceilings use a wood screw.
 - for cavity ceilings use a spring toggle bolt.
 - for solid ceilings use a rawlplug and screw.
- 2) Screw part (B) into part (A). This has a left hand thread.
- 3) Using a plumb-line, plumb down from (A) and fix floor fitting (F) to floor, using appropriate type of fixing.
- 4) Screw rod into top fitting (A) using a left hand thread and add as many additional rods as required.
- 5) Cut bottom rod in line with the decorative line around floor fitting (F).
- 6) Slide tensioner (C), spring (D) and rod grip (E) onto the rod. Tighten grip (E) to the end of the rod with allen key provided.
- 7) Adjust the tension of the rod by screwing tensioner (C) into floor fitting (F). See (G) below.

N.B. It is important to check the strength of the top fixing. No responsibility will be taken for incorrect fixing. This responsibility rests with the installer.

If using lighting on rods, we recommend that you use isolators (see illustration) at the top and bottom.

Rods are not supplied with fixing screws.

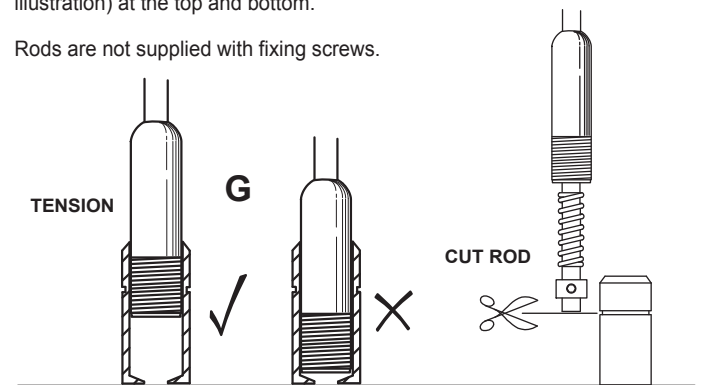

6mm Rod Display Systems - INSTALLATION GUIDELINES

Panel Fixing - RG01 & RG02 Support Installation

1) Attach a clamp support to each corner of vertical panel at min. 1" distance from edge (fig 1).

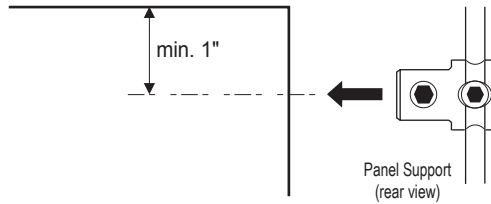

fig 1

2) Use additional clamp supports for panels taller than 60 inches to avoid bowing.

3) **Mark rod positions on floor area** - measure the distance between rods centers and mark rod positions on the floor. With the use of a plumb line mark and fix rods to ceiling (ensuring that fixings are secure).

5) Install rods as per "Rod Fixing Instructions" for RAS supplied.

6) Fix panels onto rods. Adjust panels vertically and horizontally, preferably with a spirit level. Repeat procedure for other panels.

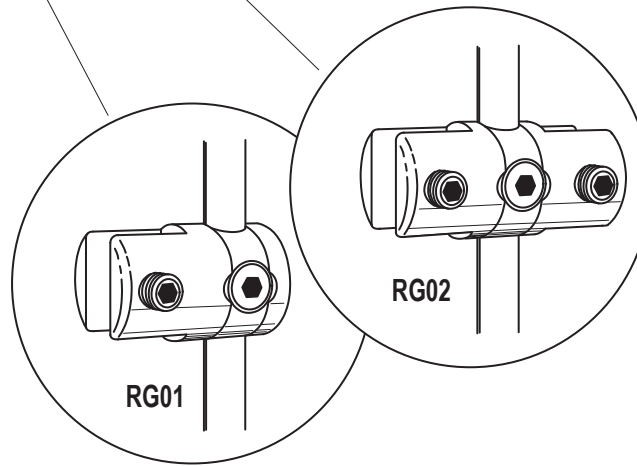
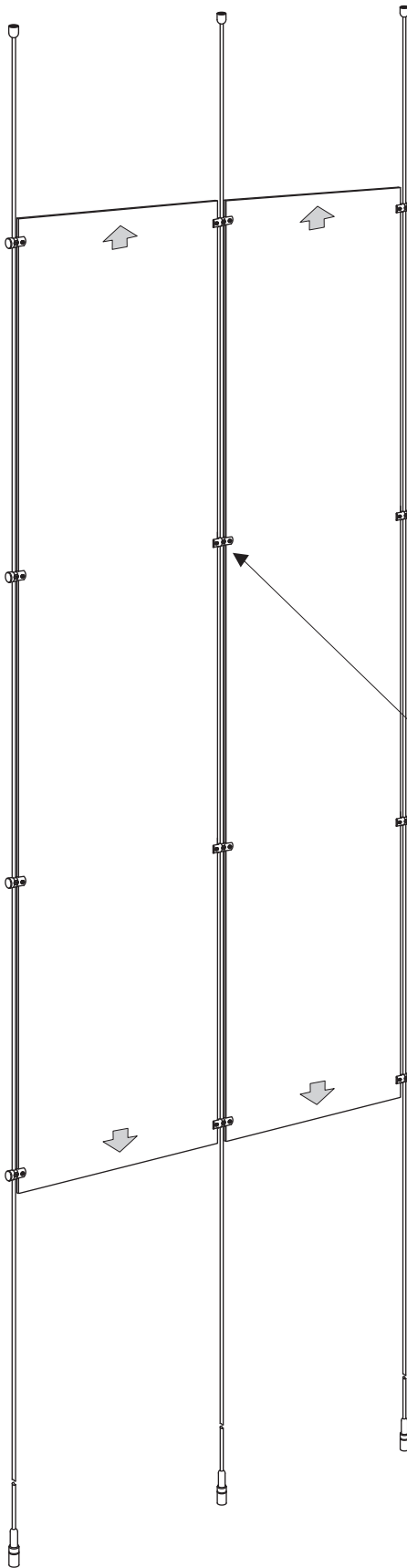

INSTALLATION TIPS

Concrete

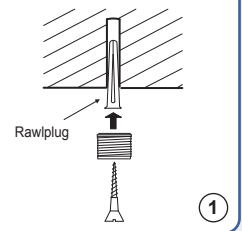

Wood

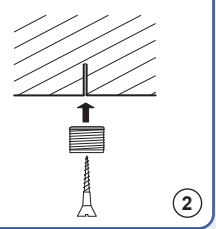

Lathe & Plaster

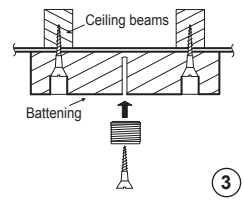

Plasterboard

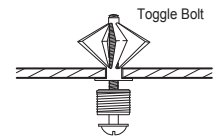

Suspended Ceiling

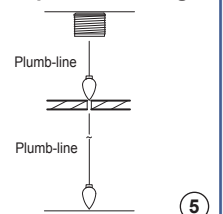

6mm Rod Display Systems - INSTALLATION GUIDELINES

Panel Fixing - RG13 & RG23 Support Installation

1) Attach a clamp support to each corner of vertical panel at min. 1" distance from edge (fig 1).

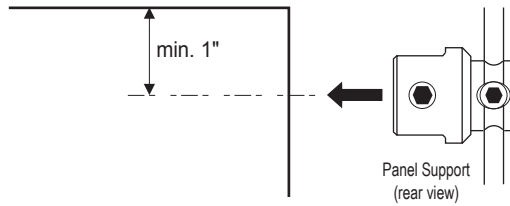

fig 1

2) Use additional clamp supports for panels taller than 60 inches to avoid bowing.

3) **Mark rod positions on floor area** - measure the distance between rods centers and mark rod positions on the floor. With the use of a plumb line mark and fix rods to ceiling (ensuring that fixings are secure).

5) Install rods as per "Rod Fixing Instructions" for RAS supplied.

6) Fix panels onto rods. Adjust panels vertically and horizontally, preferably with a spirit level. Repeat procedure for other panels.

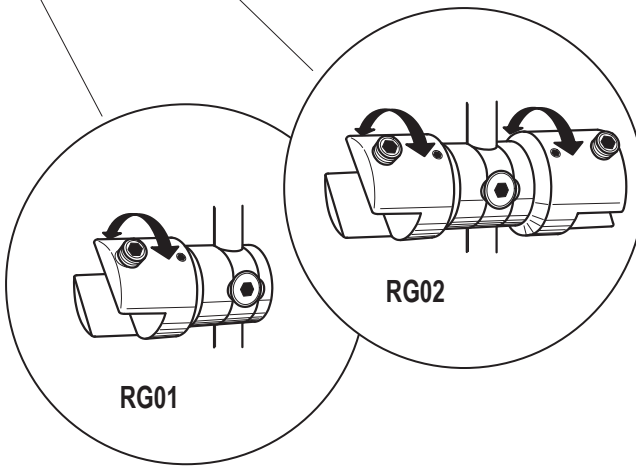
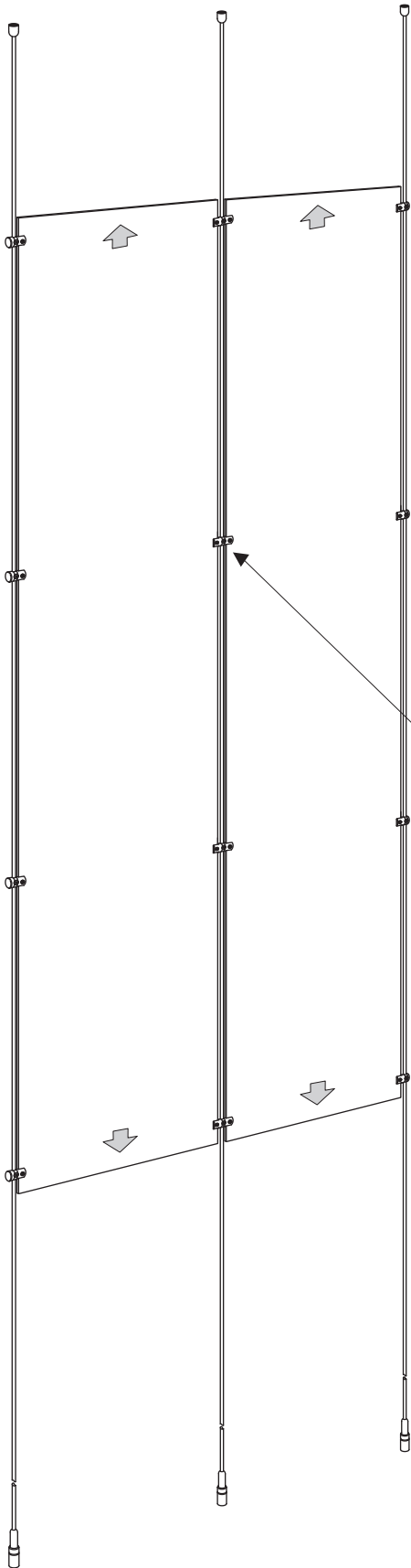

INSTALLATION TIPS

Concrete

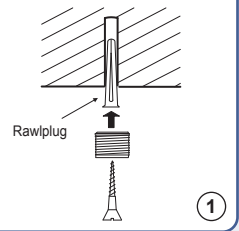

Wood

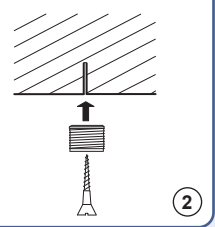

Lathe & Plaster

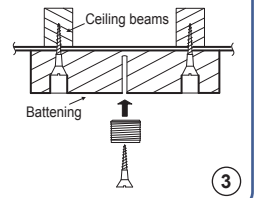

Plasterboard

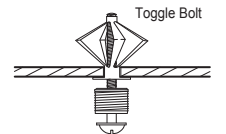

Suspended Ceiling

